

Northwest Vermont Solid Waste Management District

158 MORSE DRIVE, FAIRFAX, VT 05454
802-524-5986 • FAX: 802-524-5987

CANCELED NOTICE

NORTHWEST VERMONT SOLID WASTE DISTRICT

BOARD OF SUPERVISORS MEETING Building Committee

DATE: October 25, 2022
TIME: 3:00 PM
LOCATION: 158 Morse Drive, Fairfax
VIA ZOOM: <https://us02web.zoom.us/j/4456759564>

1. Adjustments to the Agenda
2. Welcome, introductions, opening remarks –Chair
3. Opportunity for Public Comment
4. Presented Topics:

Project Updates

5. Adjourn

MEMBER COMMUNITIES

ALBURGH • BAKERSFIELD • BERKSHIRE • ENOSBURG • FAIRFIELD • FLETCHER • FRANKLIN • GEORGIA • GRAND ISLE
HIGHGATE • ISLE LA MOTTE • MONTGOMERY • NORTH HERO • RICHFORD • ST. ALBANS CITY • ST. ALBANS TOWN
SHELDON • SOUTH HERO • SWANTON

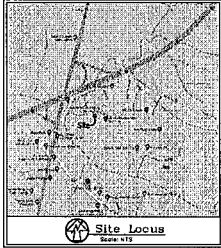
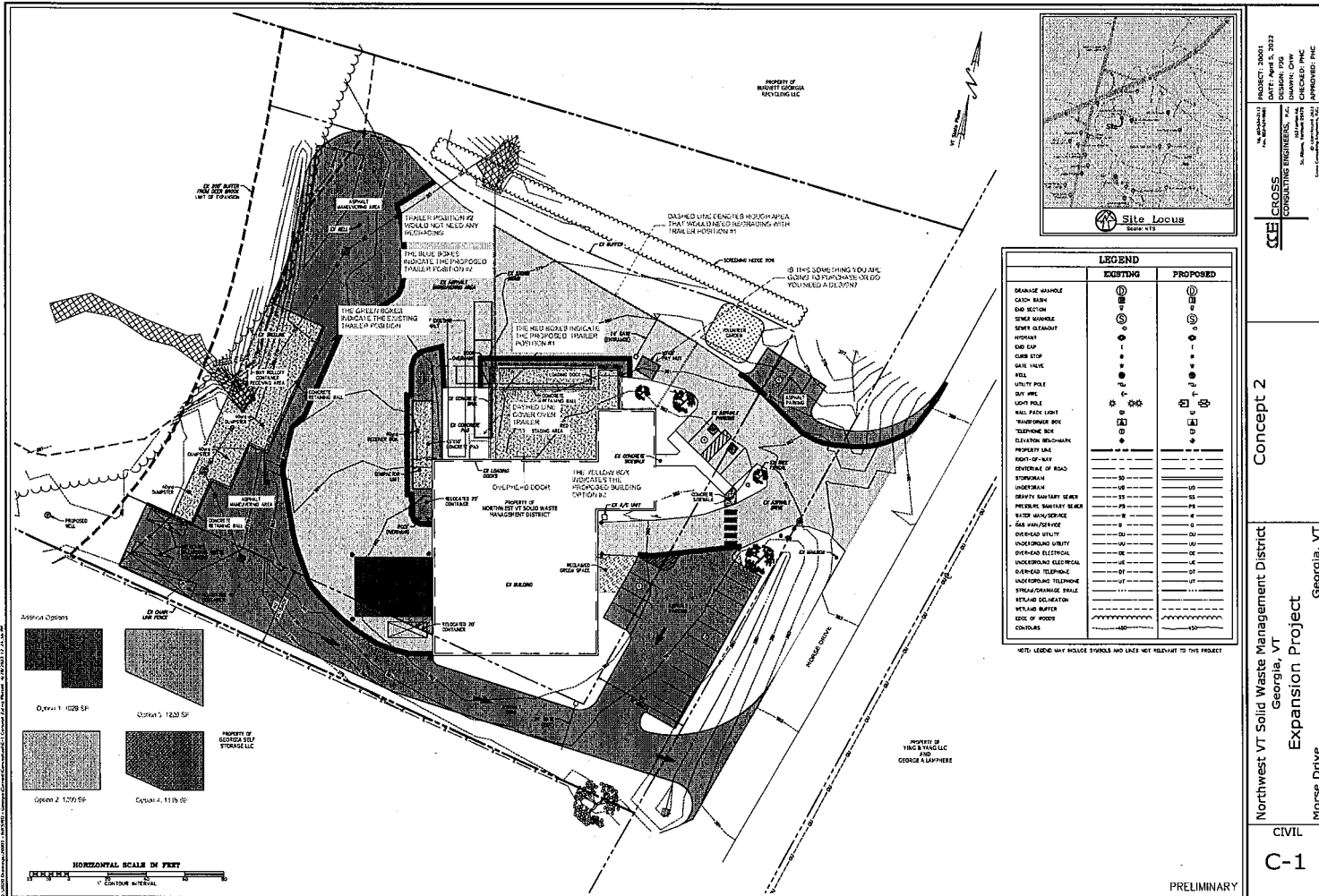

| | EXISTING | PROPOSED |
|-------------------------|----------|----------|
| DRAINAGE CHANNEL | (Symbol) | (Symbol) |
| CATCH BASIN | (Symbol) | (Symbol) |
| END SECTION | (Symbol) | (Symbol) |
| SEWER MANHOLE | (Symbol) | (Symbol) |
| SEWER OR FANOUT | (Symbol) | (Symbol) |
| MANHOLE | (Symbol) | (Symbol) |
| ODD END | (Symbol) | (Symbol) |
| CURB STOP | (Symbol) | (Symbol) |
| SALE YARD | (Symbol) | (Symbol) |
| WELL | (Symbol) | (Symbol) |
| UTILITY POLE | (Symbol) | (Symbol) |
| 50' W.P. | (Symbol) | (Symbol) |
| LIGHT POLE | (Symbol) | (Symbol) |
| RAIL FENCE LIMIT | (Symbol) | (Symbol) |
| TRANSFER BOX | (Symbol) | (Symbol) |
| TELEPHONE BOX | (Symbol) | (Symbol) |
| ELEVATION BRANCHMAN | (Symbol) | (Symbol) |
| PROPERTY LINE | (Symbol) | (Symbol) |
| RIGHT-OF-WAY | (Symbol) | (Symbol) |
| CONTINUAL OF ROAD | (Symbol) | (Symbol) |
| STORMWATER | (Symbol) | (Symbol) |
| UNDERPASS | (Symbol) | (Symbol) |
| GRAVITY SANITARY SEWER | (Symbol) | (Symbol) |
| PRESSURE SANITARY SEWER | (Symbol) | (Symbol) |
| WATER MAIN/SERVICE | (Symbol) | (Symbol) |
| GAS MAIN/SERVICE | (Symbol) | (Symbol) |
| OVERHEAD UTILITY | (Symbol) | (Symbol) |
| UNDERGROUND UTILITY | (Symbol) | (Symbol) |
| OVERHEAD ELECTRICAL | (Symbol) | (Symbol) |
| UNDERGROUND ELECTRICAL | (Symbol) | (Symbol) |
| OVERHEAD TELEPHONE | (Symbol) | (Symbol) |
| UNDERGROUND TELEPHONE | (Symbol) | (Symbol) |
| STEEL/CONCRETE RAIL | (Symbol) | (Symbol) |
| STEEL/CONCRETE RAIL | (Symbol) | (Symbol) |
| STEEL/CONCRETE RAIL | (Symbol) | (Symbol) |
| EDGE OF WOODS | (Symbol) | (Symbol) |
| CONTROLS | (Symbol) | (Symbol) |

Concept 2

Northwest VT Solid Waste Management District
Georgia, VT
Expansion Project
Morse Drive
Georgia, VT

CIVIL
C-1

PRELIMINARY

PROJECT: 20001
DATE: APRIL 5, 2012
DRAWN: CPM
CHECKED: PNC
APPROVED: PNC

Site Lotus 1000-1113